



JET CLUSTER

PF 3400 SERIES FOAM EFFECT NOZZLES

DESIGN / APPLICATION DATA:

Jet Cluster nozzles produces a vertical columns of water using connection rows of clear stream jet giving the appearance of a large diameter water columns. Due to the refractive quality of the individual streams, jet cluster nozzles offer good visibility at the long range viewing distance.

Nozzle is further enhanced when combined with submersible lighting. Applications include indoor or shielded outdoor use in commercial, institutional, municipal building and landscape projects, as a primary display features, or as peripheral accents to primary display features they are also used effectively in series or grouped in clusters.

SPECIFICATION DATA:

Material of construction is machined brass and bronze.
Female threaded connection.

OPERATING DATA:

Noise : Low to Moderate
 Visibility : Good
 Splash/Mist : Low to Moderate
 Wind Stability : Good
 Aeration Quality : Good

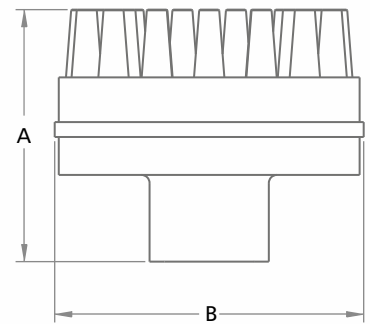

HYDRAULIC DATA

Model No.	BSP	Orifice in mm	Nos. of Jets	Dimension A (mm)	Dimension B (mm)		Stream Height in Meter					
							0.50	1.00	1.50	2.00	2.50	3.00
PF 3490	1"	4	30	98	113	LPM	66	102	132	159	183	210
						Head in Mtr	1.00	2.00	2.75	3.50	4.00	5.00
PF 3492	2"	4	45	103	202	LPM	110	170	220	265	305	345
						Head in Mtr	1.00	2.00	2.75	3.50	4.00	5.00